

AB 617 Community Air Protection Program
North-End Community: Brawley-Westmorland-Calipatria
Steering Committee Meeting Agenda
Calipatria High School Library
601 W Main Street
Calipatria, CA 92233

MEETING AGENDA
Monday, February 23, 2026
5:30 p.m. – 7:30 p.m.

Facilitator: Imperial County Air Pollution Control District

WELCOME

- 1. ROLL CALL/OPENING REMARKS BY CSC MEMBERS** **CSC**
- 2. PUBLIC COMMENT PERIOD** **CSC**
Comments are to be limited to no more than 3 minutes per person.
- 3. PRESENTATIONS:**
 - A. Title Five: Rule 900** **ICAPCD**
ICAPCD Staff will provide an update on Rule 900 and Title V.
(Attachment: [Title Five: Rule 900](#))
 - B. AB 617 North-End Community Budget Update** **ICAPCD**
ICAPCD Staff will present the budget status for the AB 617 North-End: Brawley-Westmorland-Calipatria Community.
(Attachment: [AB 617 North-End Community Budget Update](#))
 - C. AB 617 North-End Paving Proposals** **ICAPCD**
ICAPCD Staff will present review of the paving applications received from the AB 617 North-End: Brawley-Westmorland-Calipatria Community Request for Proposals for paving.
(Attachment: [AB 617 North-End Paving Proposals](#))
- 4. ACTION ITEMS**
 - A. AB 617 North-End Paving Proposals** **ICAPCD**
ICAPCD Staff will present a voting tree for the AB 617 North-End Proposals for Paving Projects.
 - 1. Westmorland Union Elementary School District: Little League Parking Lot**
 - 2. Westmorland Union Elementary School District: North Parking Lot**
 - 3. Westmorland Union Elementary School District: South Parking Lot**
 - 4. Calipatria Unified School District: Transportation Yard & Access Road**
 - 5. Brawley Elementary School District: Community Learning Center Parking Lot**
 - 6. Brawley Elementary School District: Barbara Worth Jr. High School Parking Lot**
 - 7. Brawley Union High School District: District Warehouse Parking Lot**

AB 617 Community Air Protection Program
North-End Community: Brawley-Westmorland-Calipatria
Steering Committee Meeting Agenda
Calipatria High School Library
601 W Main Street
Calipatria, CA 92233

- 8. Brawley Union High School District: District Offices & Athletic Compound
Parking Lot
- 9. City of Calipatria: Freeman Street
- 10. City of Westmorland: 1st Street
- 11. City of Westmorland: 7th Street Widening
- 12. City of Westmorland: City Hall Parking Lot

(Attachment: [AB617 North-End Paving Proposals Funding Vote](#))

5. DISCUSSION/INFORMATION ITEMS

- A. Imperial County AB 617 North-End Community Open Discussion** **CSC**
Open discussion regarding the Imperial County AB 617 North-End Community.

6. AGENCY UPDATES **CSC**

7. AGENDA TOPICS FOR NEXT MEETING **CSC**

Discuss the next CSC meeting for March 16, 2026 at the Brawley Teen Center Recreation Room (220 Magnolia Street, Brawley, CA 92227).

8. CLOSING REMARKS/AJOURNMENT **CSC**

AB 617 Programa de Protección del Aire Comunitario
Comunidad Norte: Brawley-Westmorland-Calipatria
Agenda De La Reunión Del Comité Directivo
Biblioteca de la escuela secundaria Calipatria
601 W Main Street
Calipatria, CA 92233

AGENDA DE LA REUNIÓN
Lunes, 23 de febrero, 2026
5:30 p.m. – 7:30 p.m.

Facilitador: Imperial County Air Pollution Control District

BIENVENIDO

- 1. PASO DE LISTA / PALABRAS DE APERTURA DE LOS MIEMBROS DEL CSC** **CSC**
- 2. PERIODO DE COMENTARIOS PÚBLICOS** **CSC**
Los comentarios deben limitarse a no más de 3 minutos por persona.
- 3. PRESENTACIONES:**
 - A. Título Cinco: Regla 900** **ICAPCD**
El personal de ICAPCD proporcionará una actualización sobre la Regla 900 y el Título V.
(Adjunto: [Título Cinco: Regla 900](#))
 - B. Actualización del presupuesto comunitario del norte de AB 617** **ICAPCD**
El personal de ICAPCD presentará el estado presupuestario de la comunidad de Brawley-Westmorland-Calipatria del AB 617 North-End.
(Adjunto: [Actualización del presupuesto comunitario norte de AB 617](#))
 - C. Propuestas de pavimentación del norte de AB 617** **ICAPCD**
El personal de ICAPCD presentará la revisión de las solicitudes de pavimentación recibidas desde la AB 617 Norte: Comunidad Brawley-Westmorland-Calipatria Solicitud de propuestas para pavimentar.
(Adjunto: [Propuestas de pavimentación del norte de AB 617](#))
- 4. ARTÍCULO DE ACCIÓN**
 - A. Propuestas de pavimentación del norte de AB 617** **ICAPCD**
El personal de ICAPCD presentará un árbol de votación para las Propuestas del Norte del AB 617 para Proyectos de Pavimentación.
 - 1. Westmorland Union Elementary School District: Little League Parking Lot**
 - 2. Westmorland Union Elementary School District: North Parking Lot**
 - 3. Westmorland Union Elementary School District: South Parking Lot**
 - 4. Calipatria Unified School District: Transportation Yard & Access Road**
 - 5. Brawley Elementary School District: Community Learning Center Parking Lot**
 - 6. Brawley Elementary School District: Barbara Worth Jr. High School Parking Lot**
 - 7. Brawley Union High School District: District Warehouse Parking Lot**

AB 617 Programa de Protección del Aire Comunitario
Comunidad Norte: Brawley-Westmorland-Calipatria
Agenda De La Reunión Del Comité Directivo
Biblioteca de la escuela secundaria Calipatria
601 W Main Street
Calipatria, CA 92233

- 8. Brawley Union High School District: District Offices & Athletic Compound
Parking Lot
- 9. City of Calipatria: Freeman Street
- 10. City of Westmorland: 1st Street
- 11. City of Westmorland: 7th Street Widening
- 12. City of Westmorland: City Hall Parking Lot

(Adjunto: [*Propuestas de pavimentación del norte de AB 617*](#))

5. ARTÍCULOS DE DISCUSIÓN/INFORMACIÓN

- | | |
|---|------------|
| A. Discusión abierta sobre la comunidad Norte AB 617 del condado de Imperial | CSC |
| Discusión abierta sobre la comunidad Norte AB 617 del condado de Imperial. | |

6. ACTUALIZACIONES DE LA AGENCIA	CSC
---	------------

7. TEMAS DEL AGENDA PARA LA PRÓXIMA REUNIÓN	CSC
--	------------

Discutir la próxima reunión del CSC para el 16 de marzo de 2026 en la Sala de Recreación del Brawley Teen Center (220 Magnolia Street, Brawley, CA 92227).

8. OBSERVACIONES DE CLAUSURA/CIERRE DE CLAUSURA	CSC
--	------------

3. Presentations:

A. Title Five: Rule 900 (ICAPCD)

RULE 900 AMENDMENT & TITLE V UPDATES

- **Imperial County Air Pollution Control District is currently working on possible amendments to Rule 900 removing Affirmative Defense Provisions due to US Court of Appeals decisions. The Air District is working on holding informational workshops with various stakeholders and the public. Final actions updating the rule will be pending finalization of any litigation and receiving guidance from the US EPA.**

1990 - Clean Air Act (CAA) Amendments Established Title V of CAA



1992 - First Promulgation of Affirmative Defense Provision



2001 - USEPA approved 34 Air District's Permitting Programs including Imperial County APCD



2011 - ICAPCD Rule 900 revised for GHG levels (submitted to EPA but not acted on)



2016 - USEPA proposed rule to remove emergency affirmative defense from Title V



USEPA determined the affirmative defense provisions in their programs was inconsistent with their interpretation of the enforcement structure



Given the court's decision USEPA decided to review other programs

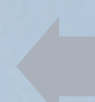

2014 - US Court of Appeals vacated affirmative defense provision in the USEPA's hazardous pollutant regulations for the Portland Cement Industry



2018 - USEPA withdrew proposal to remove emergency affirmative defense



2022 - USEPA submitted new proposal under the same title to remove emergency affirmative defense



2023 - USEPA removed emergency affirmative defense provisions from Title V



2023 - ICAPCD Withdrew 2011 Rule 900 Revision as EPA Title V Rule



2025 - US Court of Appeals reversed the recission of the emergency affirmative defense from Title V

AIR DISTRICT ACTIONS

• Steps completed

- Air District has begun analyzing possible changes to Rule 900 Language and possible changes to Title V Permit Language
- Air District has requested Cities provide member contacts for an Advisory Board for local jurisdiction input
- Cities have designated members to sit on the Advisory Board and Air District has provided information regarding Advisory Board
- Air District has begun holding informational workshops to Title V Permit Holders/Facilities
- Air District has begun providing informational updates to members of the public

• Future Steps

- Air District will begin scheduling workshops with Advisory Board members
- Air District will schedule additional public information workshops including various stakeholders
- Air District will prepare proposed language changes and staff report to be presented to Air Pollution Control District Board
- Air District will remain in communication with EPA for final guidance for compliance with final legal decisions

3. Presentations:
B. AB 617 North-End
Community Budget Update
(ICAPCD)

North End AB 617 Corridor Budget Update

Incentive Funds	Grant Amount	Status	Amount PAID	Liquidation Date
CAP Year 6	\$ 3,750,000.00	Pending	\$ -	6/30/2027
CAP Year 8	\$ 4,744,401.23	Pending	\$ -	6/30/2033
	\$ -		\$ -	

TOTAL	\$	8,494,401.23	\$	-
--------------	-----------	---------------------	-----------	----------

3. Presentations:
**C. AB 617 North-End Paving
Proposals
(ICAPCD)**

AB 617 NORTH-IMPERIAL

1ST ROUND PAVING PROJECTS

Highest Emission
Reduction Proposals

Projects & Description	Project Cost (\$)	Surface Area (sqft)	Emission Reductions (tons/year)	Cost- Effectiveness (\$/ton of PM10)	Max Grant Amount (\$)
<u>SCHOOL (100%)</u> Westmorland Union Elementary School District: Little League Parking Lot Location: 200 South C St., Westmorland, CA 92281 (33.033881, -115.617293)	\$982,146.98	28,831 sqft	0.48 tons/year	\$234,976.00 /ton of PM10	\$982,146.98
Westmorland Union Elementary School District: North Parking Lot Location: 200 South C St., Westmorland, CA 92281 Cafeteria Parking Lot (33.035956, -115.617607)	\$575,627.52	14,363 sqft	0.01 tons/year	\$5,848,137.05 /ton of PM10	\$575,627.52
Westmorland Union Elementary School District: South Parking Lot Location: 200 South C St., Westmorland, CA 92281 Staff/Visitor Parking Lot North of Bus Barn (33.034973, -115.618469)	\$268,965.96	6,955 sqft	0.05 tons/year	\$517,368.99 /ton of PM10	\$268,965.96
Calipatria Unified School District: Transportation Yard & Access Road Location: 601 W Main St., Calipatria, CA 92233 Cross streets are Main Street and Hornet Drive (33.123233, -115.525516)	\$1,394,375.82	47,580 sqft	2.21 tons/year	\$72,205.60/ton of PM10	\$1,394,375.82

AB 617 NORTH-IMPERIAL

1ST ROUND PAVING PROJECTS

Highest Emission
Reduction Proposals

Projects & Description	Project Cost (\$)	Surface Area (sqft)	Emission Reductions (tons/year)	Cost- Effectiveness (\$/ton of PM10)	Max Grant Amount (\$)
<u>SCHOOL (100%)</u> Brawley Elementary School District: Community Learning Center Parking Lot Location: 330 South 2nd Street, Brawley, CA 92227	\$421,720.68	14,470 sqft	0.25 tons/year	\$193,142.87/ton of PM10	\$421,720.68
Brawley Elementary School District: Barbara Worth Jr. High Parking Lot Location: 217 N. Imperial Ave., Brawley, CA 92227	\$647,644.14	19,961 sqft	0.19 tons/year	\$382,922.56 /ton of PM10	\$647,644.14
Brawley Union High School District: District Warehouse Location: 575 D Street, Brawley, CA 92227	\$484,504.88	17,250 sqft	0.19 tons/year	\$299,027.32/ton of PM10	\$484,504.88
Brawley Union High School District: District Offices & Athletic Compound Location: 650 N. 2nd Street, Brawley, CA 92227	\$744,432.75	42,738 sqft	2.18 tons/year	\$38,973.88/ton of PM10	\$744,432.75

AB 617 NORTH-IMPERIAL 1ST ROUND PAVING PROJECTS

Highest Emission
Reduction Proposals

Projects & Description	Project Cost (\$)	Surface Area (sqft)	Emission Reductions (tons/year)	Cost- Effectiveness (\$/ton of PM10)	Max Grant Amount (\$)
<u>GOVERNMENT (85%)</u> City of Calipatria: Freeman Street Location: Calipatria, CA 92233 From Industrial Ave. & Brown Ave. (33.132220, -115.507004)	\$804,986	11,063 sqft	0.12 tons/year	\$676,112.04 /ton of PM10	\$684,238
City of Westmorland: 1st Street Location: Westmorland, CA 92281 From D St. to the Little League Field	\$712,635	25,770 sqft	0.22 tons/year	\$315,365.29 /ton of PM10	\$605,739.75
City of Westmorland: 7th Street Widening Location: Westmorland, CA 92281 From Martin Rd. to Center St.	\$1,502,074	51,685 sqft	3.25 tons/year	\$44,914.39 /ton of PM10	\$1,276,762.90
City of Westmorland: City Hall Parking Lot Location: 355 South Center St., Westmorland, CA 92281	\$740,866	40,904 sqft	0.22 tons/year	\$327,150.04 /ton of PM10	\$629,736

A wide-angle photograph of a gravel-covered area. In the background, there is a small white building, a chain-link fence, and some sports equipment like bleachers and a backstop. A white car is parked near the building. To the right, there is a large orange storage container.

Westmorland Union Elementary School District:

A photograph of an asphalt parking lot. A chain-link fence runs across the foreground. In the background, there are trees, a clear blue sky, and some buildings. A white storage container is visible on the left side of the lot.

Little League Parking Lot

Site Plan & Aerial Map

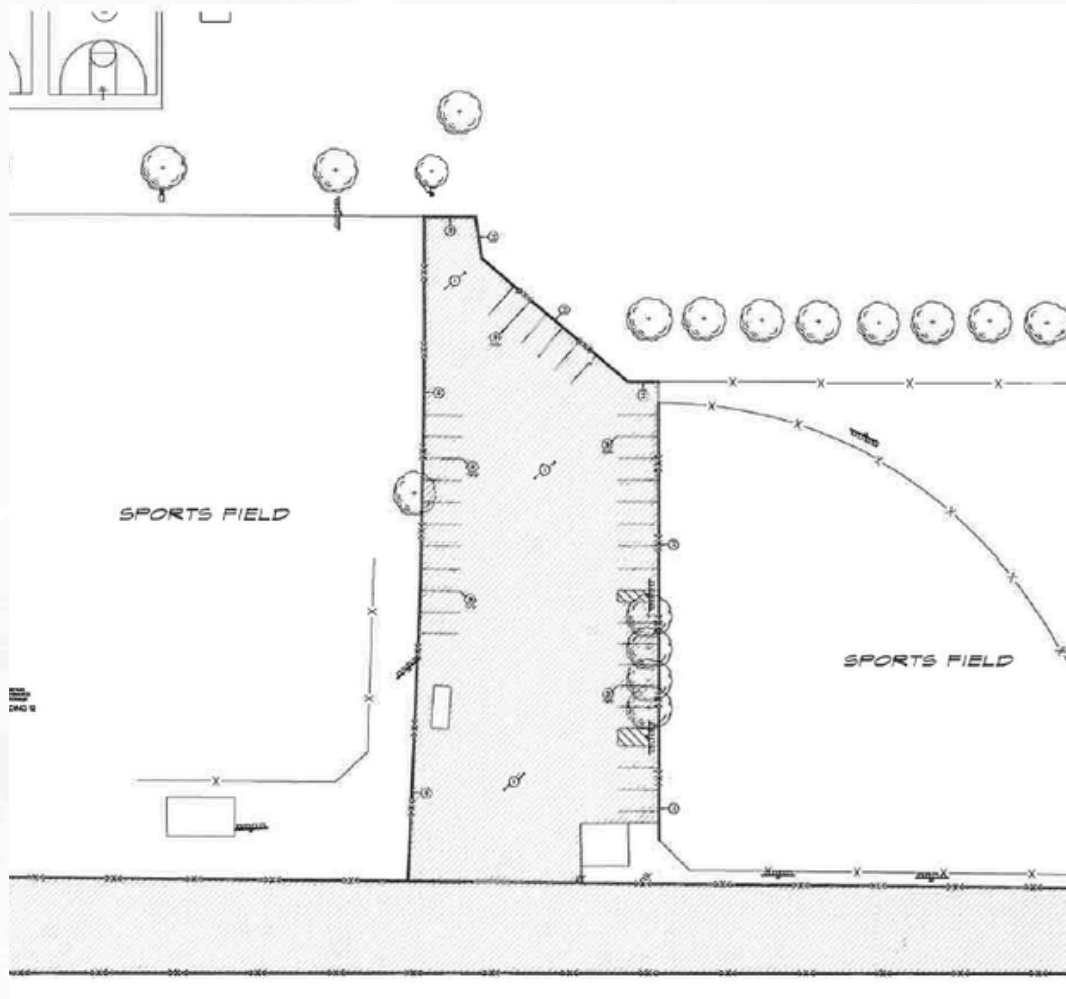



Westmorland Union Elementary School District:

North Parking Lot



Site Plan & Aerial Map

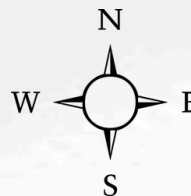
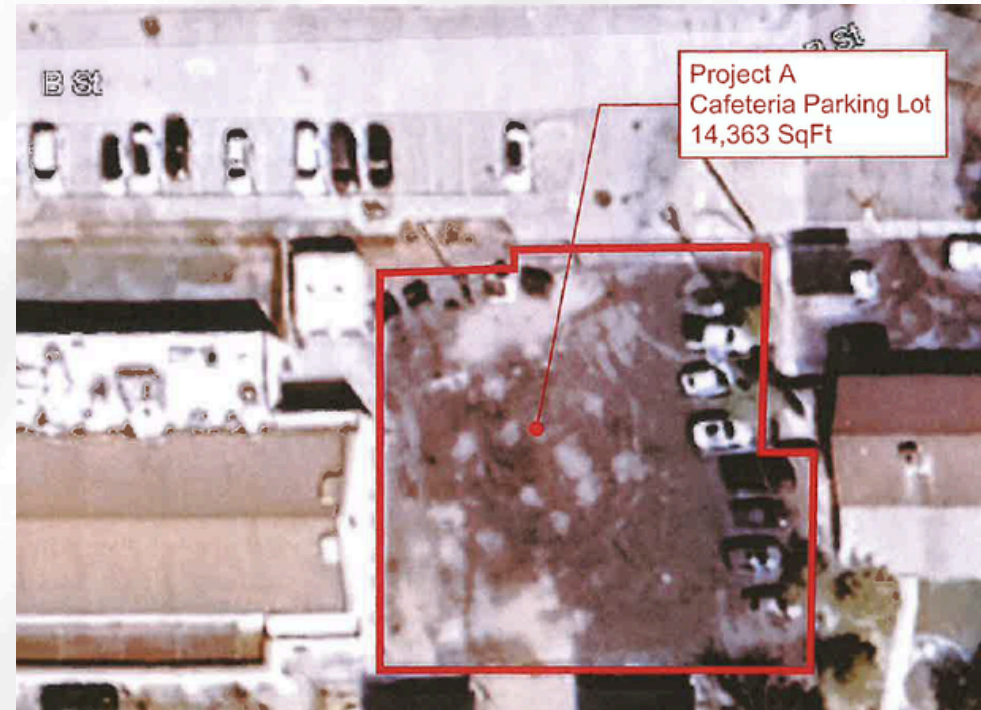
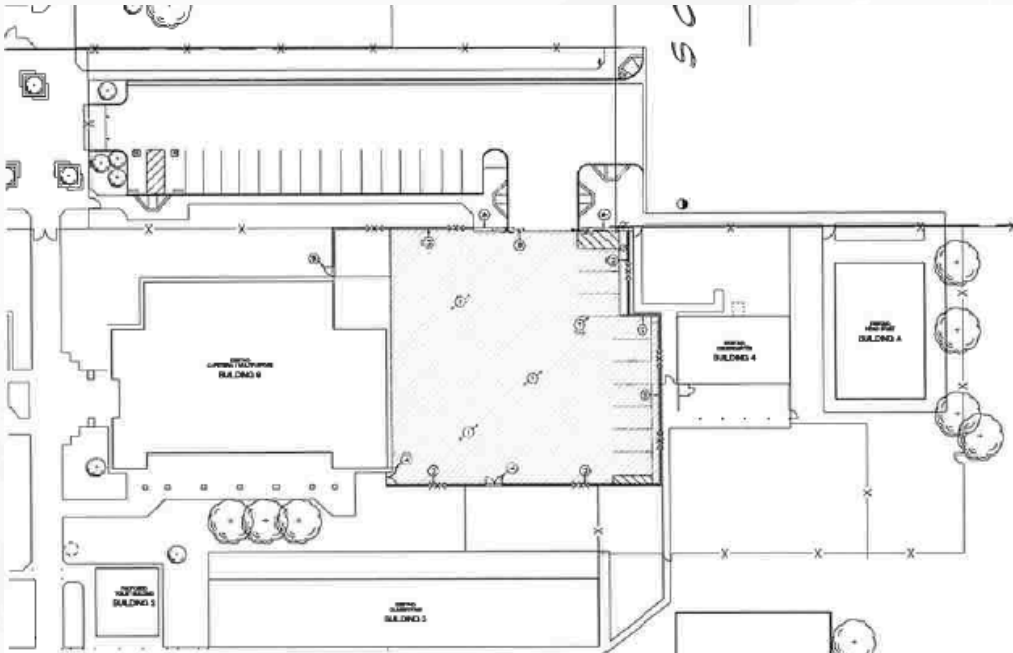



Site Plan & Aerial Map

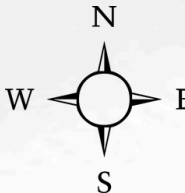
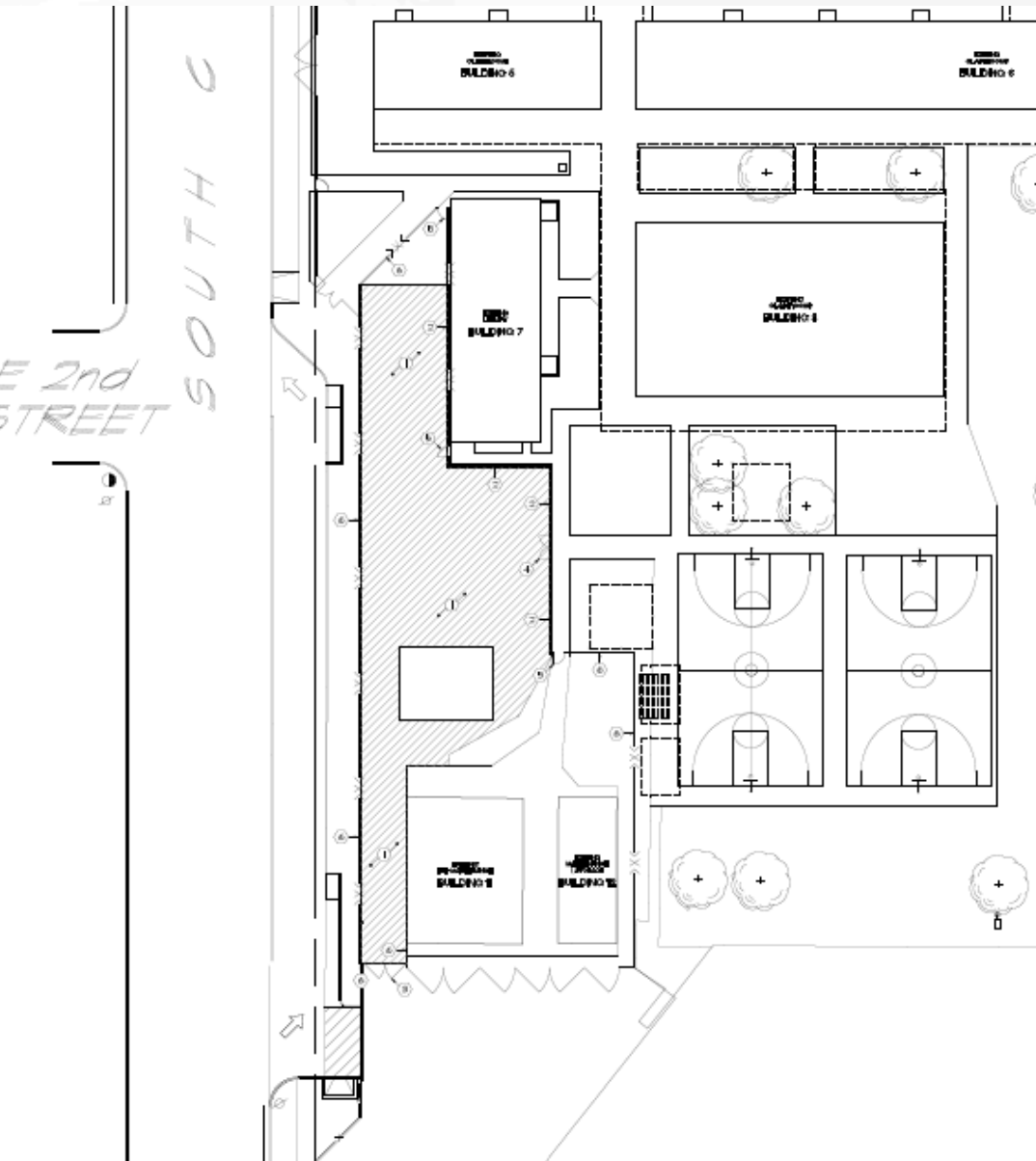



Calipatria Unified School District: Transportation Yard & Access Road



Site Plan & Aerial Map

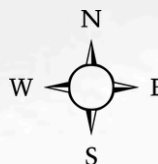
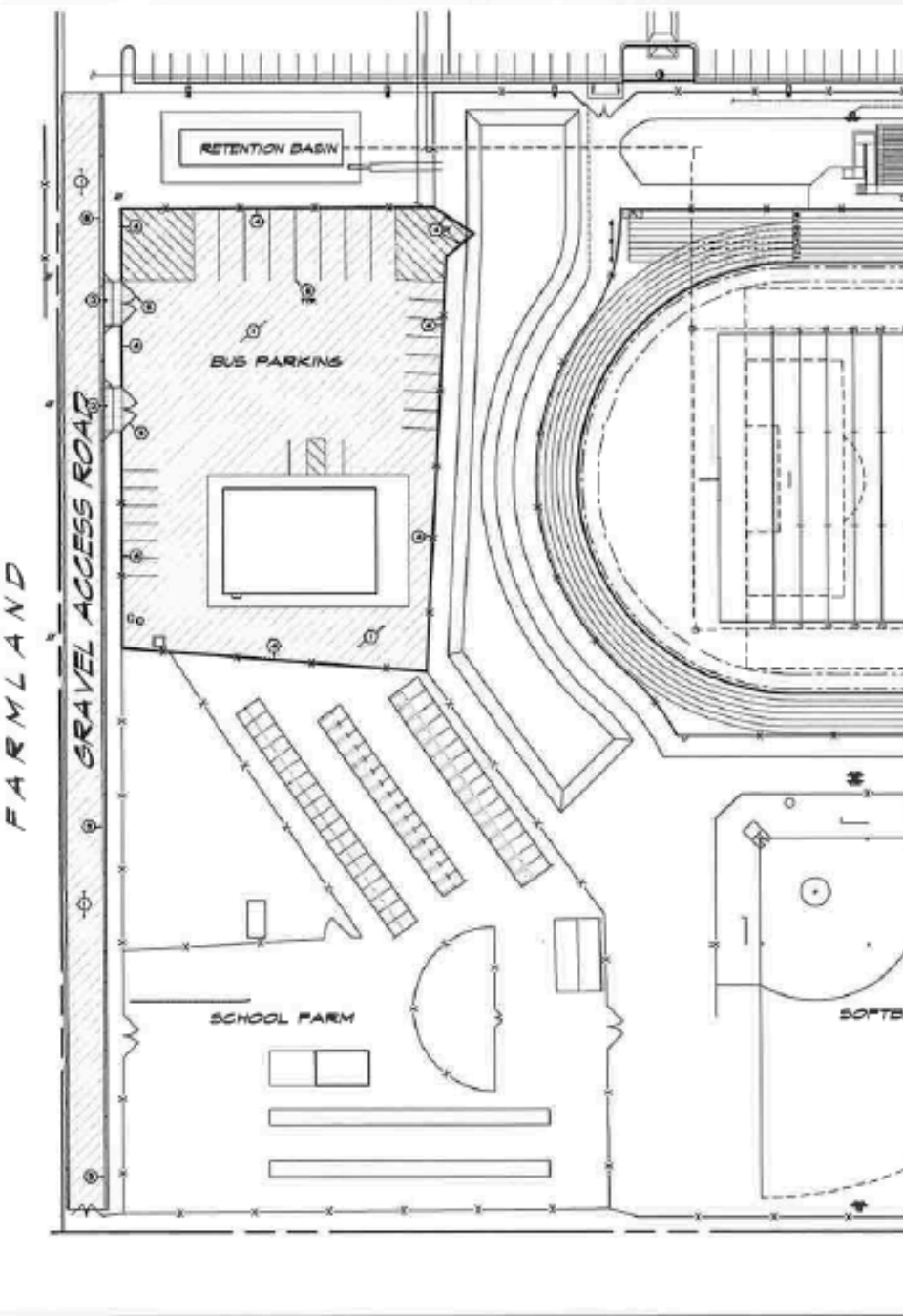



Brawley Elementary School District: Community Learning Center Parking Lot



Site Plan & Aerial Map

N. SECOND ST.

1	2	3	4	5	6	7	8	9	10	11	12	13	14	15	16	17	18	19	20	21	22	23	24	25	26	27	28	29	30	31	32	33	34	35	36	37	38	39	40	41	42	43	44	45	46	47	48	49	50	51	52	53	54	55	56	57	58	59	60	61	62	63	64	65	66	67	68	69	70	71	72	73	74	75	76	77	78	79	80	81	82	83	84	85	86	87	88	89	90	91	92	93	94	95	96	97	98	99	100
---	---	---	---	---	---	---	---	---	----	----	----	----	----	----	----	----	----	----	----	----	----	----	----	----	----	----	----	----	----	----	----	----	----	----	----	----	----	----	----	----	----	----	----	----	----	----	----	----	----	----	----	----	----	----	----	----	----	----	----	----	----	----	----	----	----	----	----	----	----	----	----	----	----	----	----	----	----	----	----	----	----	----	----	----	----	----	----	----	----	----	----	----	----	----	----	----	----	----	-----

"D" STR

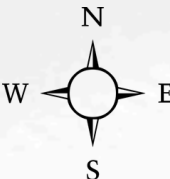
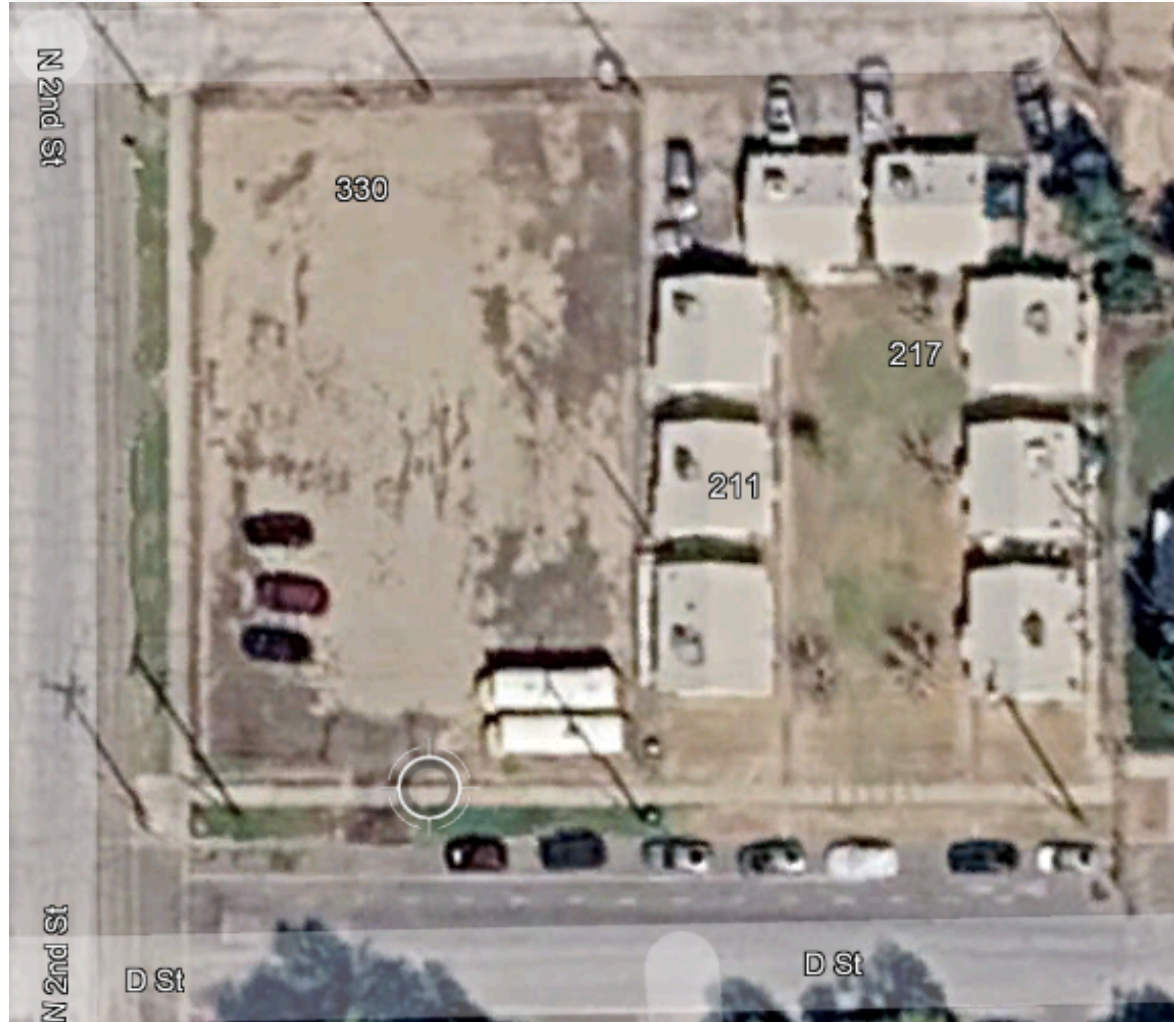



Brawley Elementary School District: Barbara Worth Jr. High Parking Lot



Site Plan & Aerial Map

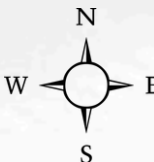
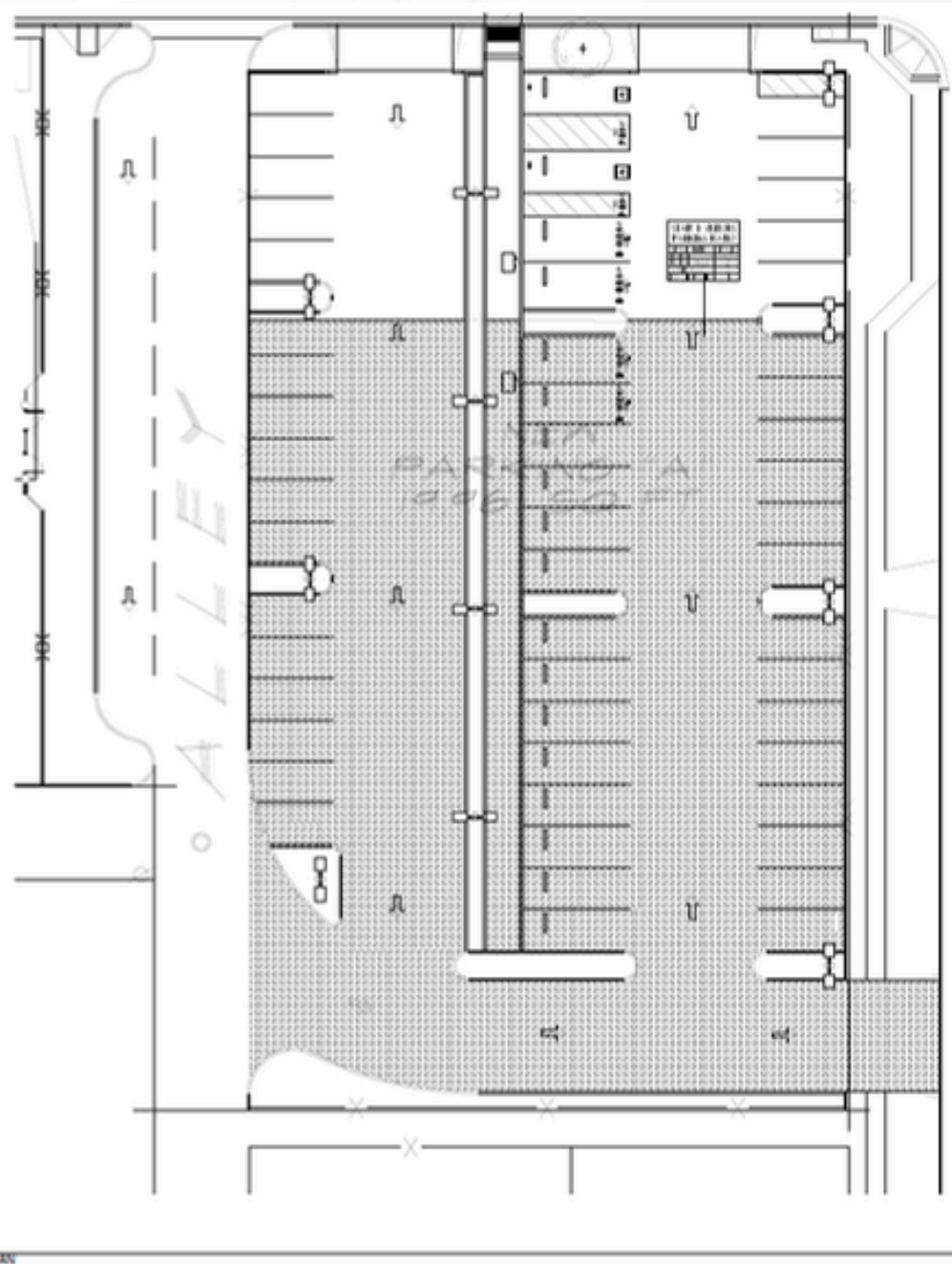



Brawley Union High School District: District Warehouse Parking Lot



Site Plan & Aerial Map

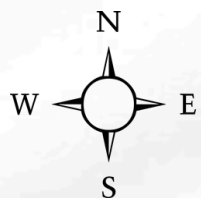
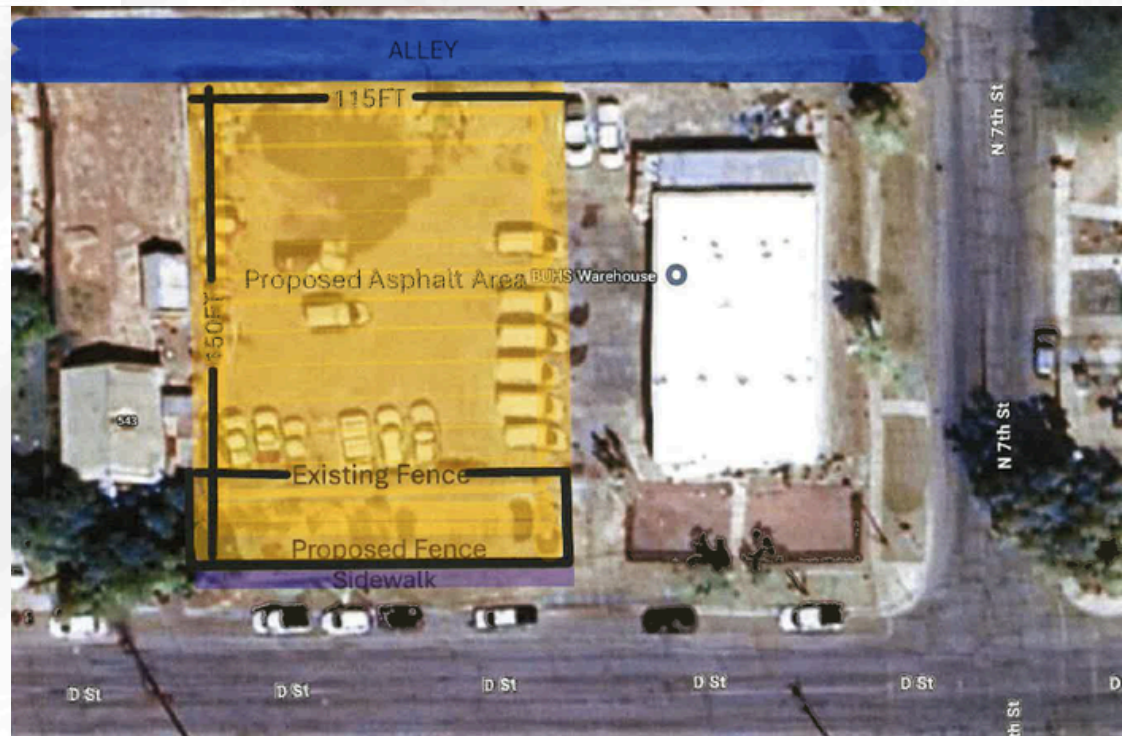
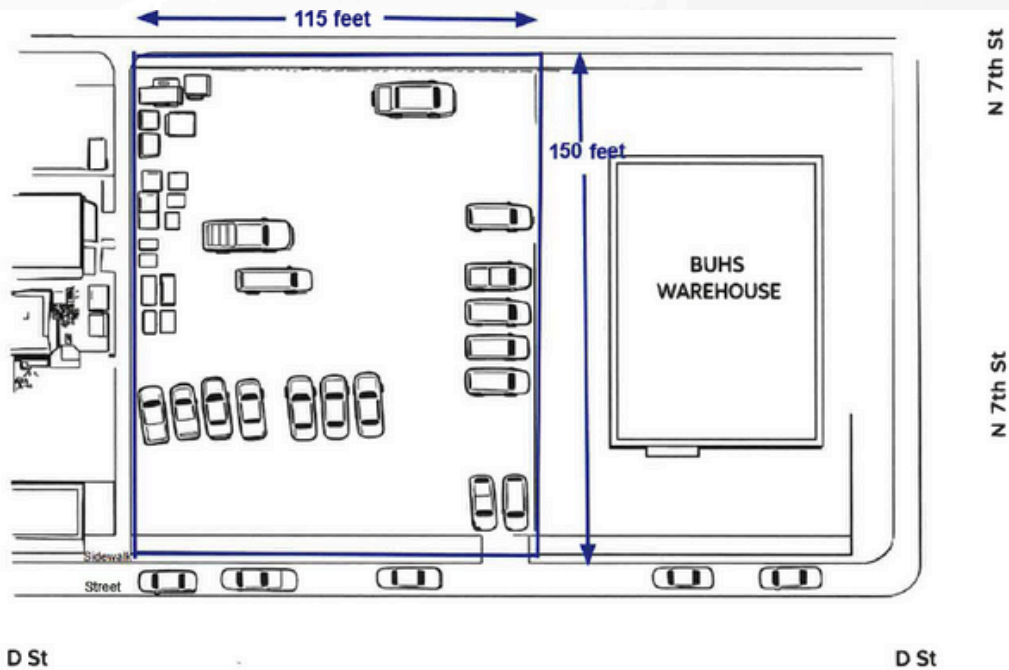



Brawley Union High School District: District Offices & Athletic Compound Parking Lot



Site Plan & Aerial Map

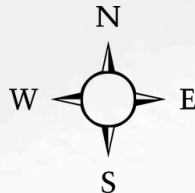
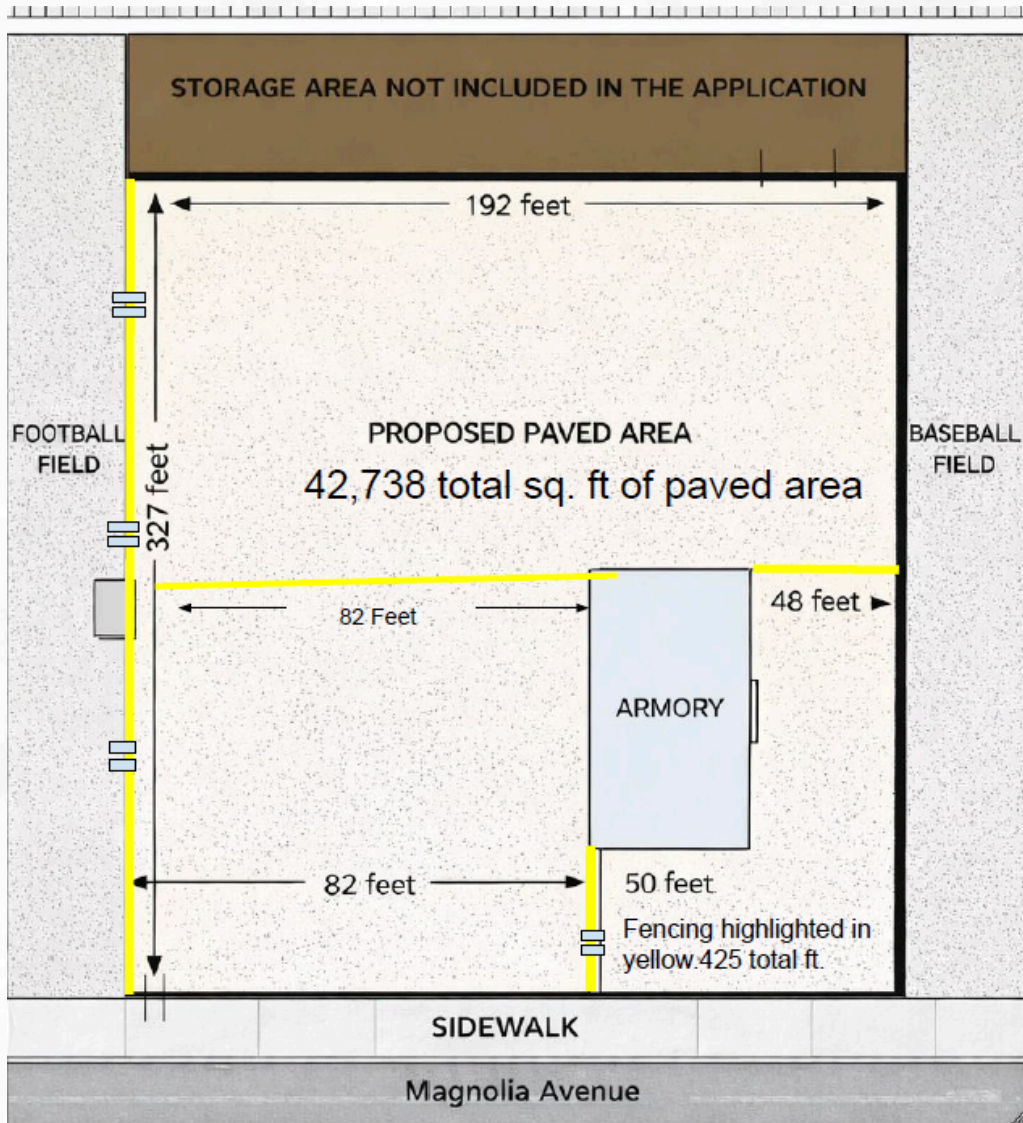



City of Calipatria: Freeman Street



Site Plan & Aerial Map

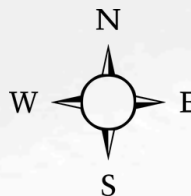
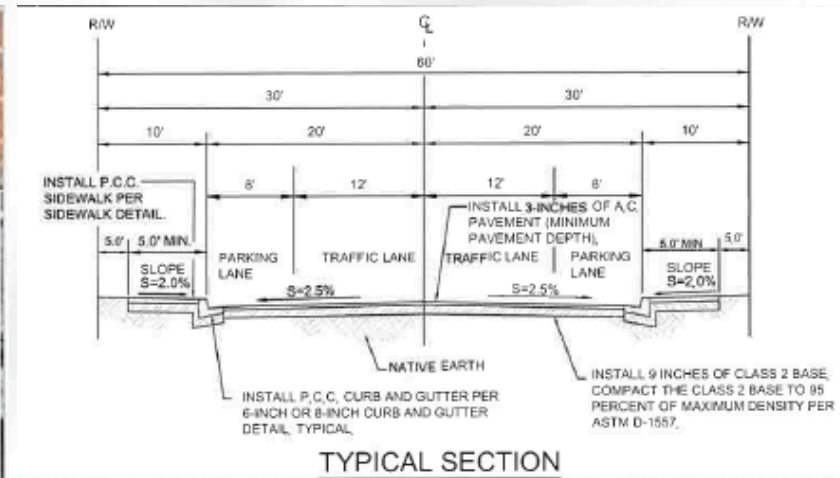



City of Westmorland: 1st Street



Site Plan & Aerial Map

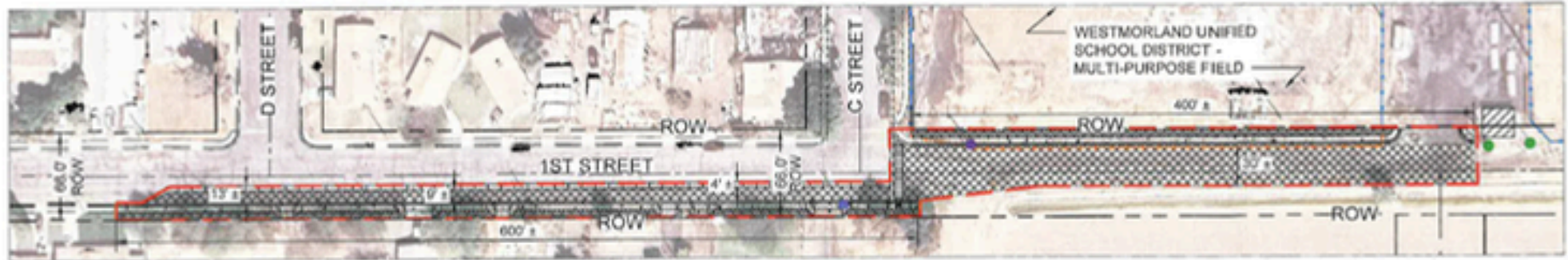

THIS SCHEMATIC DRAWING IS PREPARED FOR CONCEPT ONLY. RIGHTS-OF-WAY ARE NOT SHOWN ACCURATELY AND THE ACTUAL RIGHTS-OF-WAY ARE TO BE DETERMINED DURING THE DESIGN PHASE OF PROJECT.

LEGEND	
1. EXISTING POWER POLES TO BE RELOCATED.	
2. EXISTING FENCE LINE TO BE RELOCATED.	
3. EXISTING FENCE LINE TO REMAIN.	
4. EXISTING POWER POLE TO REMAIN.	
5. EXISTING BUILDING TO REMAIN.	
6. EXISTING CURB AND GUTTER TO REMAIN.	
7. A.C. PAVEMENT AND PEDESTRIAN FACILITY LIMITS OF CONSTRUCTION.	
8. NEW A.C. PAVEMENT TO BE INSTALLED.	
9. EXISTING PAVEMENT REPAIR TO MATCH GRADES	
10. PROPOSED P.C.C. CURB AND GUTTER AND SIDEWALK TO BE INSTALLED.	
11. PROPOSED P.C.C. DRIVEWAY TO BE INSTALLED.	
12. PROPOSED P.C.C. ADA HANDICAP RAMP AND CROSSWALK TO BE INSTALLED.	
13. PROPOSED NATIVE MATERIAL BACKING TO BE INSTALLED.	

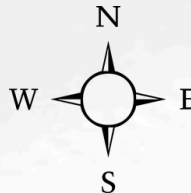



City of Westmorland:
7th Street Widening

Site Plan & Aerial Map



THIS SCHEMATIC DRAWING IS PREPARED FOR
CONCEPT ONLY.
RIGHTS-OF-WAY ARE NOT SHOWN
ACCURATELY AND THE ACTUAL
RIGHTS-OF-WAY ARE TO BE DETERMINED
DURING THE DESIGN PHASE OF PROJECT.

LEGEND

1. EXISTING POWER POLES TO BE RELOCATED.
2. EXISTING CISTERN TO REMAIN.
3. EXISTING CURB AND GUTTER TO REMAIN.
4. ROAD WIDENING WITH PEDESTRIAN FACILITY INSTALLATION.
5. INSTALL PEDESTRIAN FACILITY ONLY.
6. PEDESTRIAN FACILITY INSTALLATION WITH EXISTING DRIVEWAY ACCESS MODIFICATIONS.
7. PAVEMENT TAPER TO MATCH EXISTING ROAD.
8. INSTALL NEW ADA ACCESSIBLE CURB RAMPS.

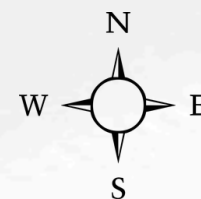



City of Westmorland: City Hall Parking Lot



Site Plan & Aerial Map

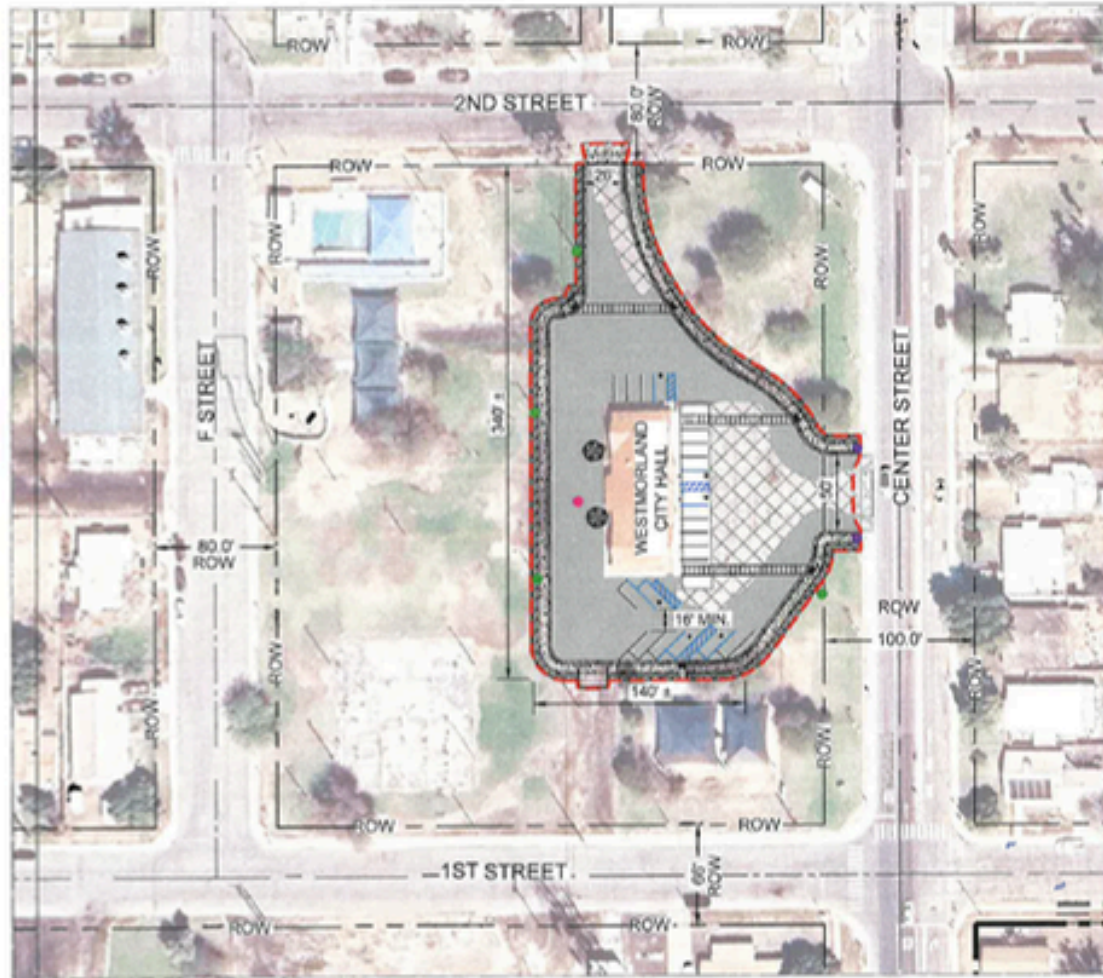

LEGEND	
1. EXISTING LIGHT POLES TO BE RELOCATED.	
2. EXISTING LIGHT POLE TO REMAIN.	
3. EXISTING UTILITY POLE TO BE RELOCATED.	
4. EXISTING TREE TO BE REMOVED.	
5. EXISTING P.C.C. DRIVEWAY TO REMAIN.	
6. EXISTING A.C. PAVEMENT TO REMAIN.	
7. PROPOSED A.C. PAVEMENT TO BE INSTALLED.	
8. PROPOSED P.C.C. CURB AND GUTTER AND SIDEWALK TO BE INSTALLED.	
9. PROPOSED P.C.C. DRIVEWAY TO BE INSTALLED	
10. PROPOSED P.C.C. ADA ACCESSIBLE HANDICAP CURB RETURN AND CROSSWALK TO BE INSTALLED.	
11. PROPOSED NATIVE MATERIAL BACKING TO BE INSTALLED.	
12. PROPOSED PARKING STALL WITH ADA PARKING STALL AND LOADING ZONE.	
13. LIMITS OF CONSTRUCTION	

THIS SCHEMATIC DRAWING IS PREPARED FOR CONCEPT ONLY. RIGHTS-OF-WAY ARE NOT SHOWN ACCURATELY AND THE ACTUAL RIGHTS-OF-WAY ARE TO BE DETERMINED DURING THE DESIGN PHASE OF PROJECT.



The Holt Group
ENGINEERING PLANNING SURVEYING



EXHIBIT:

PROJECT B : CITY OF WESTMORLAND
WESTMORLAND CITY HALL PARKING LOT PAVING AND PARKING STALL INSTALLATION

SHEET: 2

OF 3 SHEETS

1801 N. Imperial Ave.
201 E. Hobsonway

(7) Centro, Ca 92243
Blythe, Ca 92225

760.337.3883
760.922.4658

PROJECT: AB 617 GRANT APPLICATION
CLIENT: CITY OF WESTMORLAND

DATE: 10/27/25

BY: C A S

JOB NUMBER: 102.117

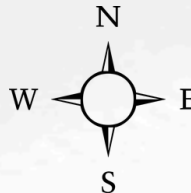

4. Action Items:

A. AB 617 North-End Paving Proposals (ICAPCD)

AB 617 NORTH-IMPERIAL

1ST ROUND PAVING PROJECTS

4.A.1)

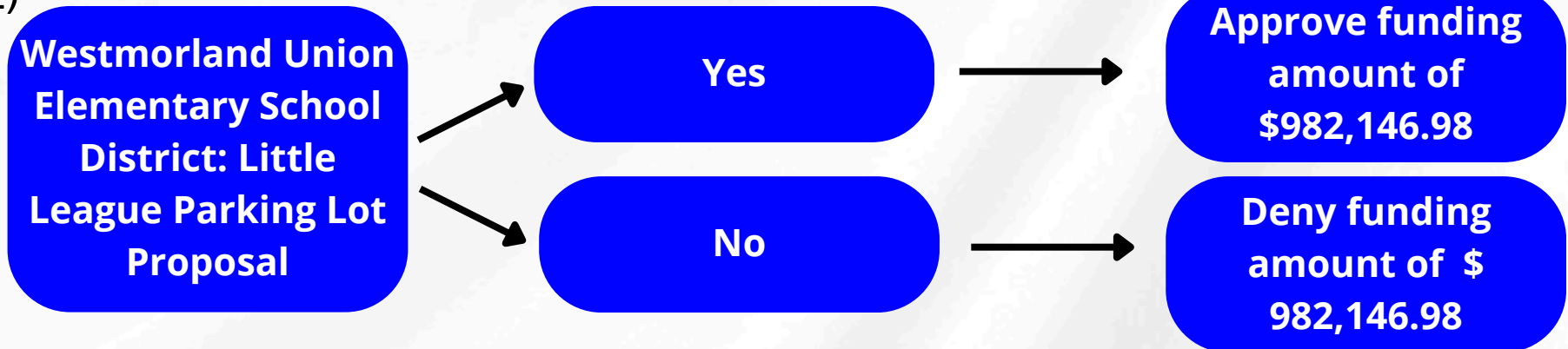

4.A.2)

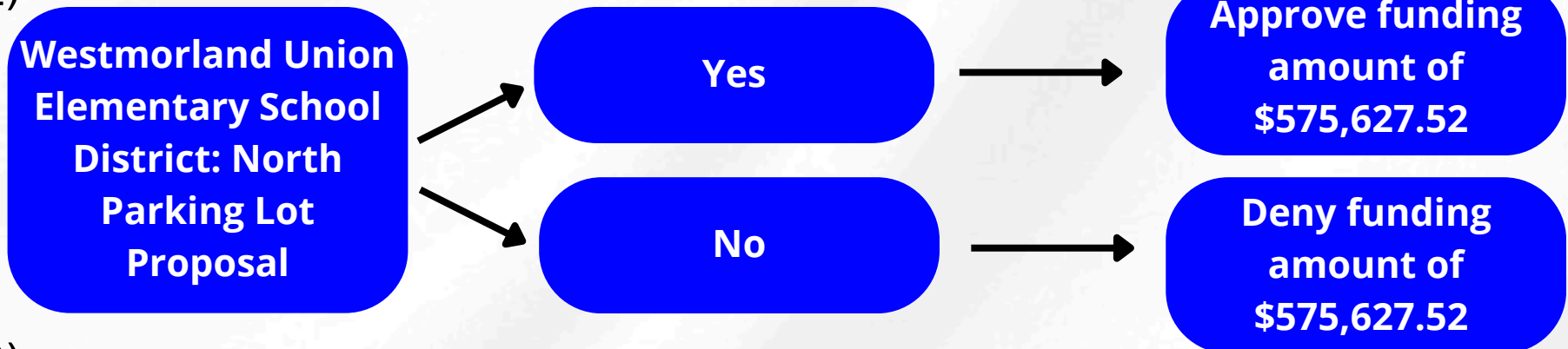

4.A.3)

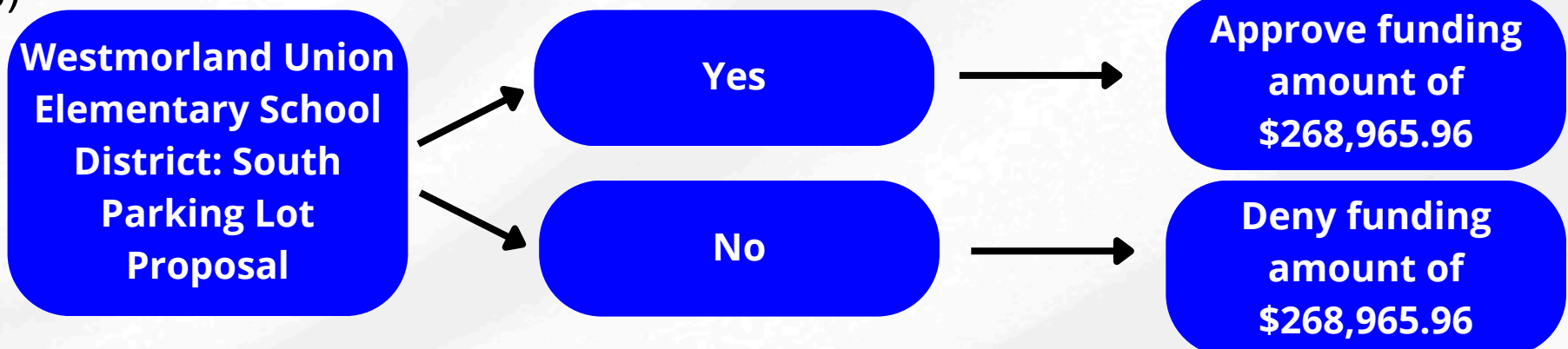

AB 617 NORTH-IMPERIAL

1ST ROUND PAVING PROJECTS

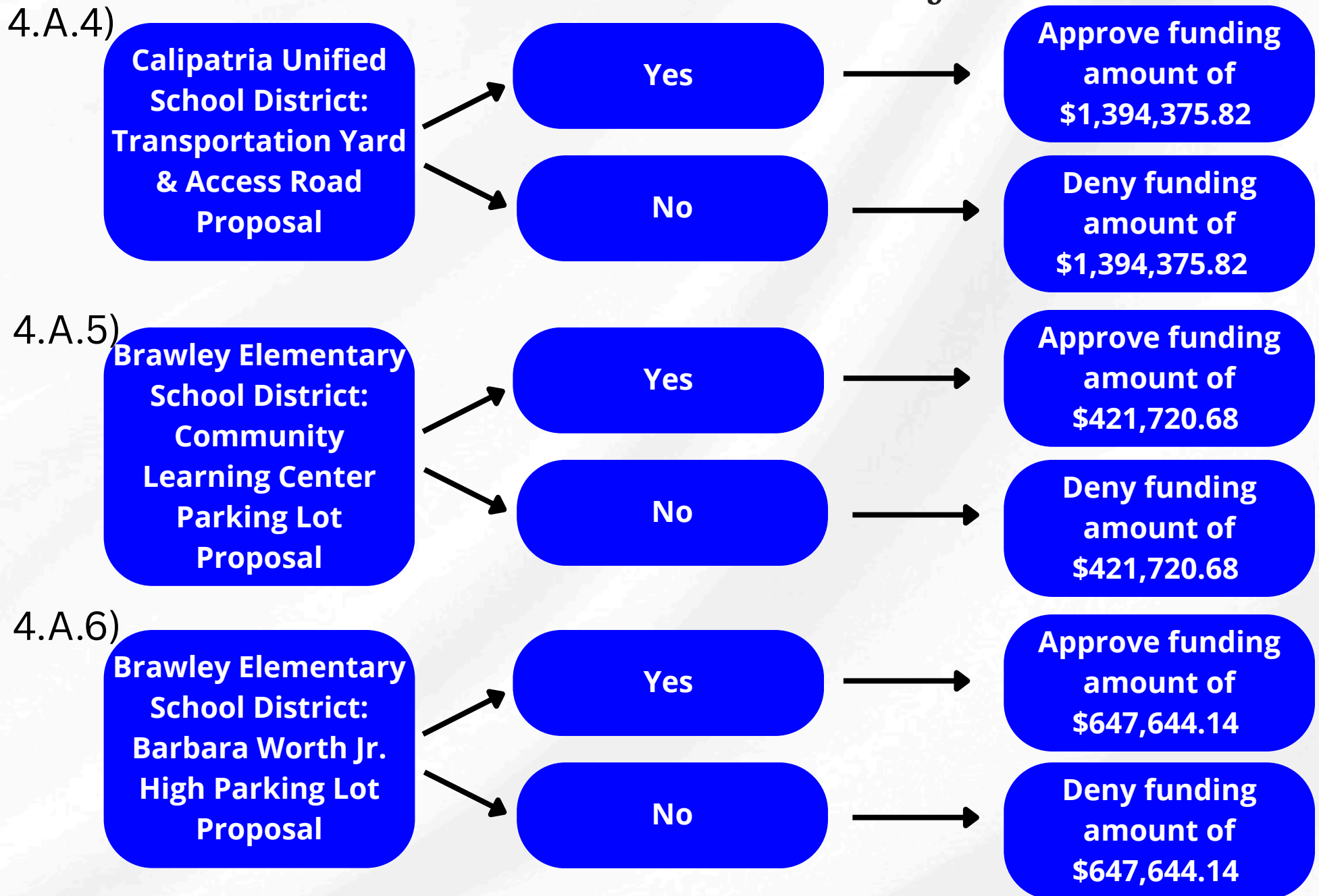

AB 617 NORTH-IMPERIAL

1ST ROUND PAVING PROJECTS

4.A.7)

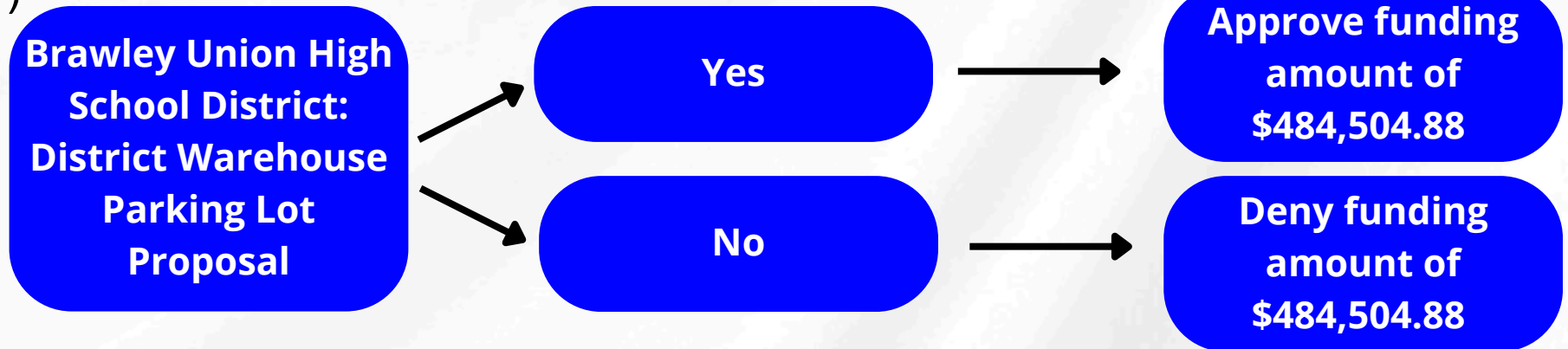

4.A.8)

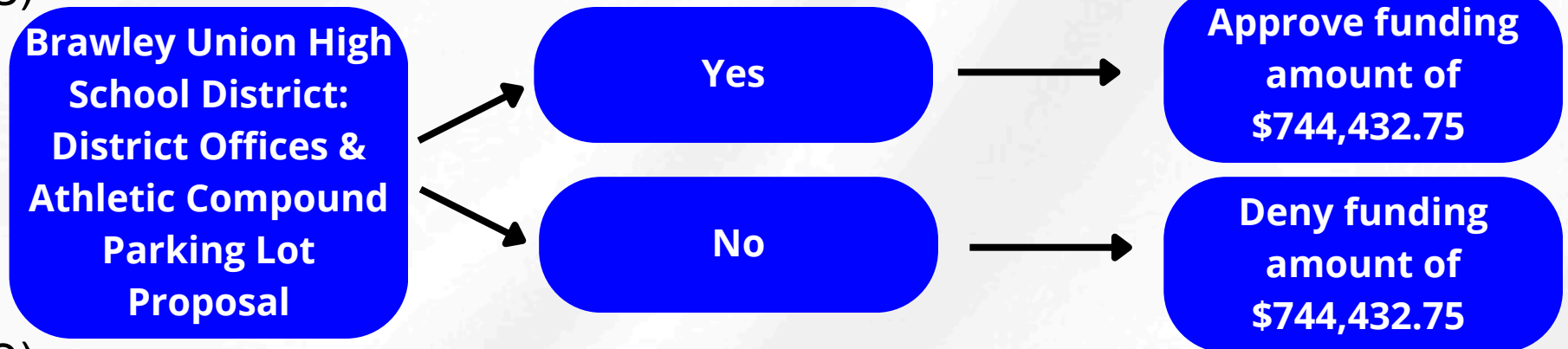

4.A.9)

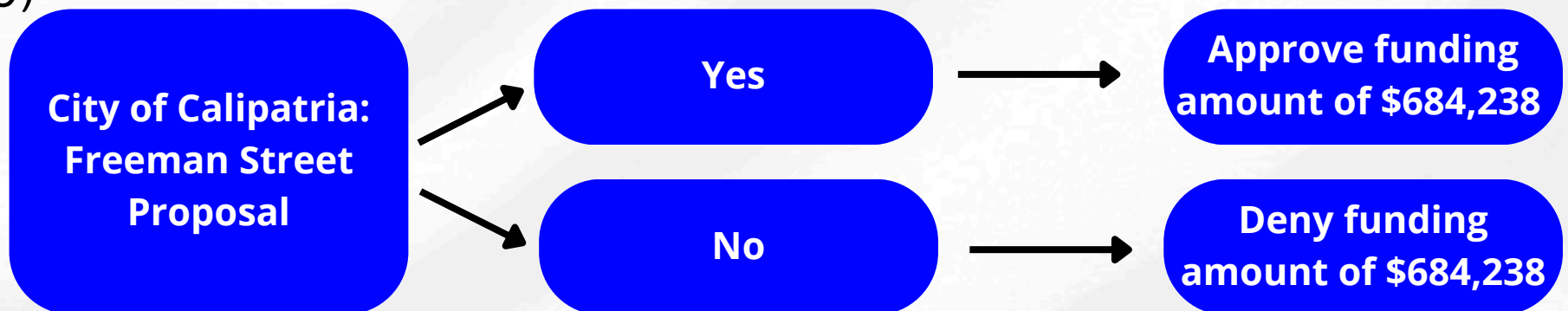

AB 617 NORTH-IMPERIAL

1ST ROUND PAVING PROJECTS

4.A.10)

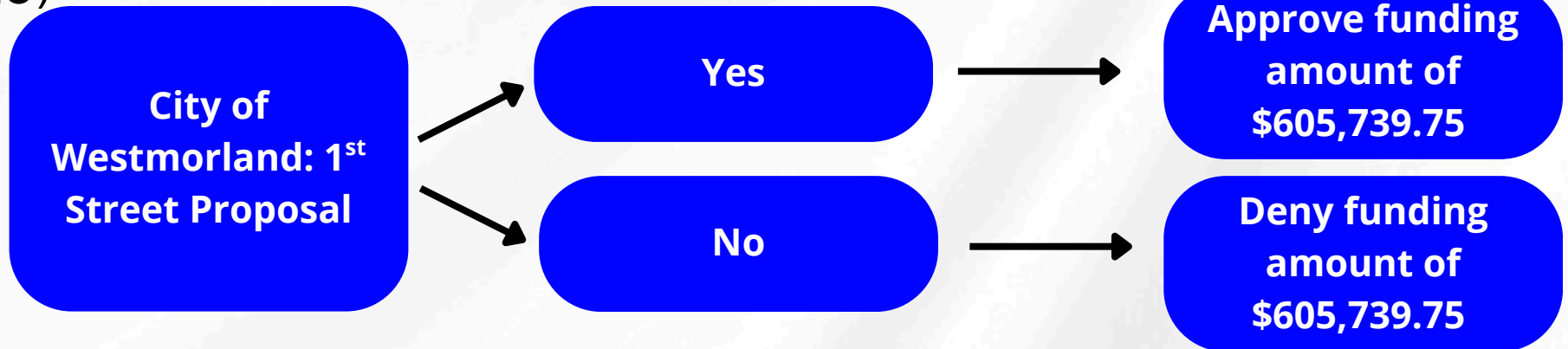

4.A.11)

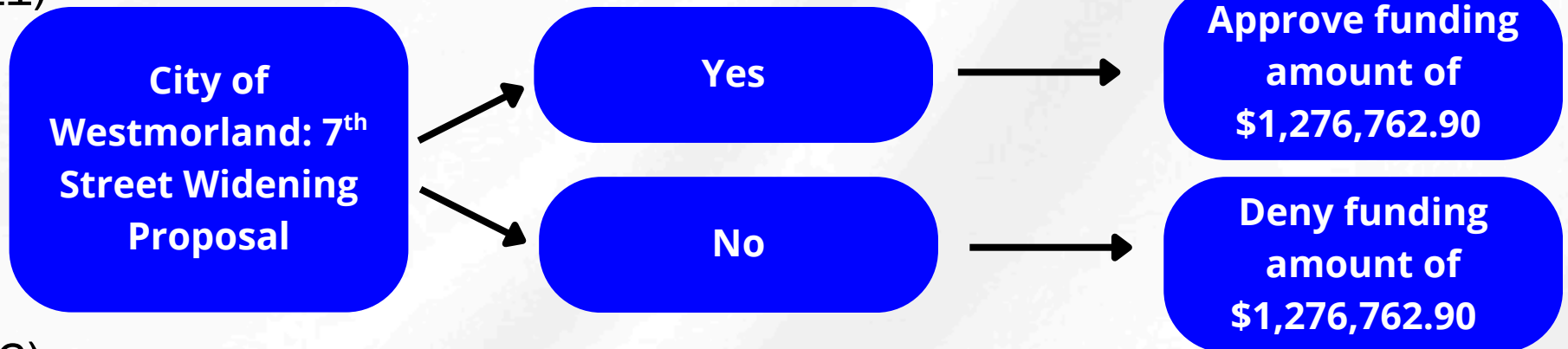

4.A.12)

